

**PLAN**  
N.T.S.

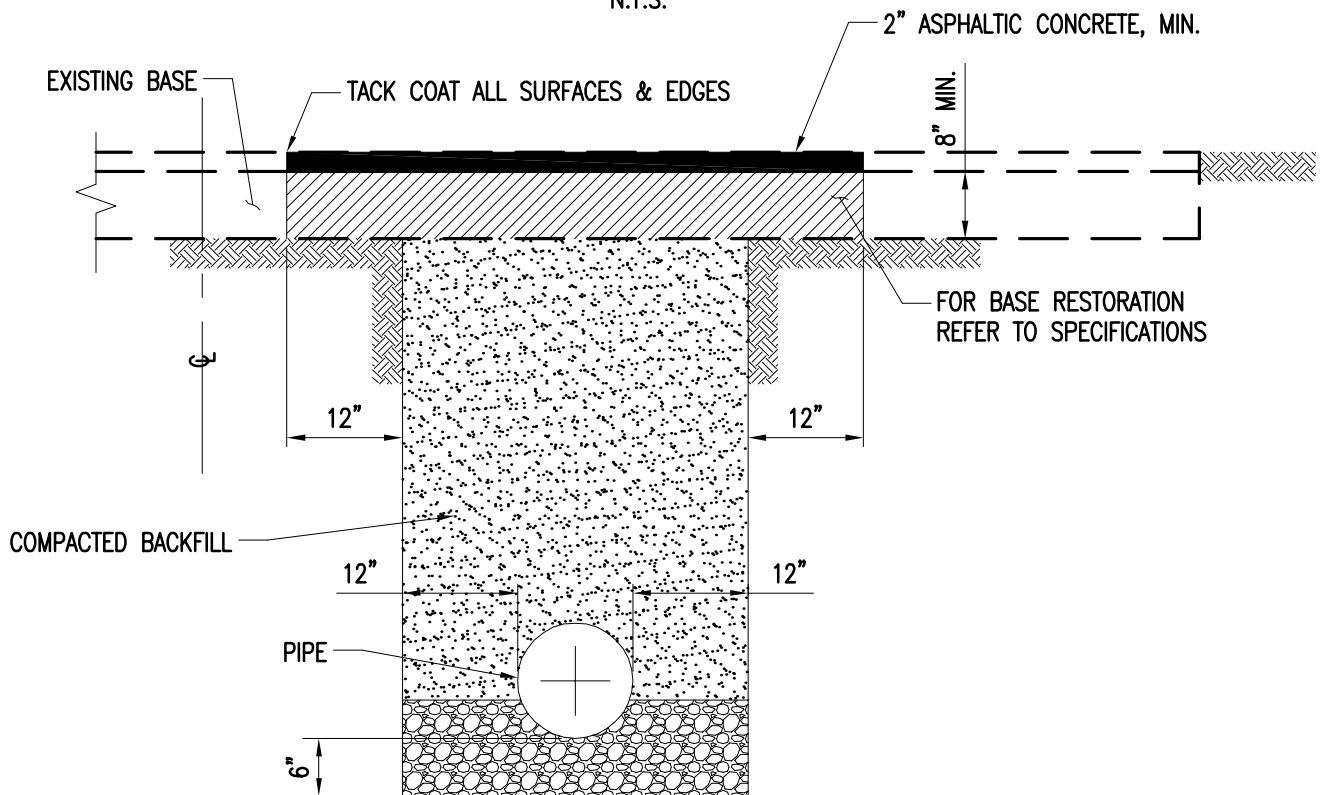

**SECTION A**  
N.T.S.

**NOTES:**

1. UNLESS OTHERWISE SPECIFIED, ALL ASPHALTIC CONCRETE DRIVEWAYS OR OIL-SAND DRIVEWAYS SHALL BE REPLACED WITH TYPE I PAVEMENT RESTORATION WITH 1" ASPHALTIC CONCRETE AND 6" BASE.
2. FOR PAVEMENT RESTORATION, REFER TO D.O.T., MIAMI-DADE COUNTY PUBLIC WORKS OR SPECIFIC MUNICIPALITY STANDARDS.

ITEM	CROSS REF.	SPEC. REF.



ISSUE DATE	APPROVED BY
10/07/2010	V.F.C.

STANDARD DETAIL  
**PAVEMENT RESTORATION  
TYPE I**

**A**  
**1.0**  
SHEET 1 OF 1